



GRP BUILT OFF-SITE.
SAVE TIME ON-SITE.

INSTALLATION GUIDES

COPEKING®

GRP COPING



To ensure optimum performance please follow the correct fitting procedures outlined in this installation guide.

Site safety and good building practice should be adhered to at all times.

Contents

Safety on Site - storage and handling **3**

COPEKING® GRP Coping - Installation Instructions **4-5**

Storage and Handling

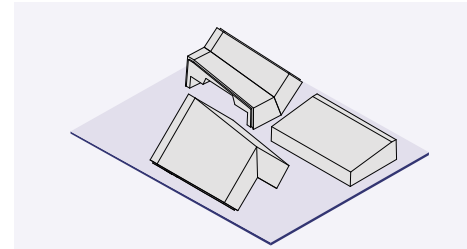

MUST BE STORED FLAT

Use timber bearers to provide support for all GRP elements.

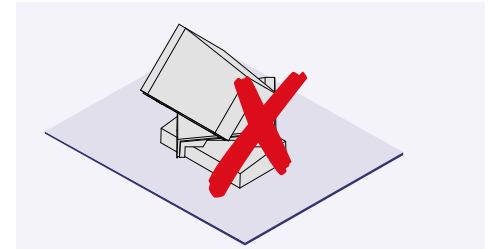

DO NOT STACK

GRP elements must not be stacked or have heavy weights placed on top.

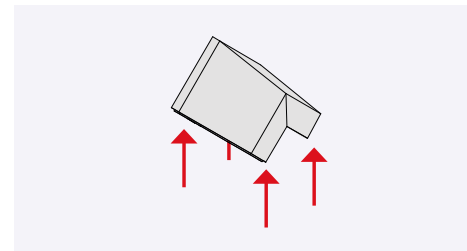

LIFTING INTO POSITION

GRP elements must be evenly supported on each side when lifting on to brackets.

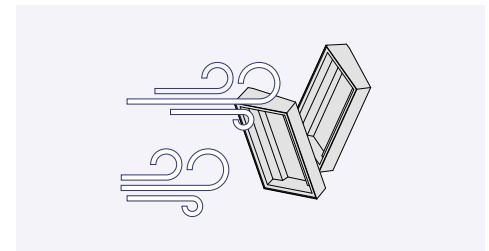

PROTECT FROM WIND

Lightweight items should be secured to prevent from wind damage on site.

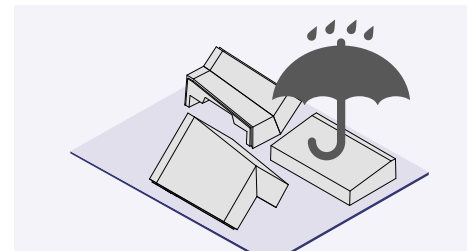

PROTECT FROM SOAKING

GRP should be stored in dry conditions. Don't store in direct sunlight when packaging is wet. Avoid soaking.



SITE SAFETY

Please observe all Site Safety guidelines and observe safe working loads when lifting mechanically.

Technical helpline:

01827 311100

www.stormking.co.uk

COPEKING® GRP Coping

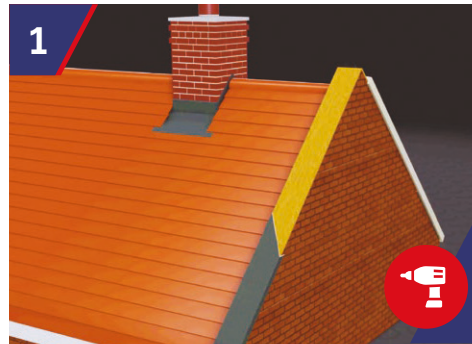

1 You will require an 18mm exterior quality plywood board to be fixed to the top of the wall. Weather proof the plywood with a polythene DPM or similar and cut off excess to allow 25mm overhang to each side of the plywood.



2 Fix the continuous plastic fixing strip to the plywood/DPM using two rows of 5x25mm coated wood screws (not supplied) spaced 60mm apart at 300mm centres. Ensure the fixing strip is central to the wall and adjoining lengths run in line. The fixing strip can be cut to any desired length to suit site conditions.



3 Clip fix all the pre mitred internal, external angles, apex mitres, base mitres and stop end units by firmly pressing COPEKING® down onto the fixing strip until "clicked" into position.



4 For fitting COPEKING® stop end, take length of strap within clip pack supplied with each stop end. Attach half of strap to underside of stop end using 2 no. screws and washers supplied. Clip fit stop end onto fixing rail and slide to desired position. Ensuring the strap is pulled taut, screw fix remaining half of strap down through fixing rail and into parapet wall using x2 remaining screws and washers.



5 Clip all standard straight lengths between fixed junction units firmly pressing down onto fixing strip until "clicked" into position. If necessary, COPEKING® can be removed by gently prizing one side away from the wall until the holding down clip is released. Repeat for the other side. The white clips factory fitted internally to the COPEKING need to be fully located onto the fixing track as indicated in the above close-up.



To complete a run of COPEKING® with a non-standard length of COPEKING®:

1. Measure the gap requiring COPEKING®.
2. Using a fine tooth saw or angle grinder, cut a section of COPEKING® to the desired length from one end of a standard COPEKING®. Ensure the cut section of COPEKING® does not have a feature joint at the end.
3. Fix the loose clip provided onto the underside of the COPEKING® at the cut end.
4. Clip fix the section of COPEKING® onto the fixing strip.

Technical helpline:

01827 311100

www.stormking.co.uk

Technical helpline:
01827 311100
www.stormking.co.uk



GRP BUILT OFF-SITE.
SAVE TIME ON-SITE.

Contact our friendly sales team:

01827 311100 or
sales@stormking.co.uk

Customer Care Enquiries:
customer@stormking.co.uk

Account Enquiries:
accounts@stormking.co.uk



Stormking, Amington Point, Sandy Way,
Amington Industrial Estate, Tamworth,
Staffordshire B77 4ED

Due to variations in the photographic and printer processes, colours shown in this brochure may vary from the actual product. We reserve the right to change the specification of these products without prior notification. E&OE.

*Free nationwide delivery, excludes highlands and islands.



www.stormking.co.uk

Stormking is a trading name of Specialist Building Products Limited, a wholly owned subsidiary of the Epwin Group Plc. Specialist Building Products Limited is registered in England & Wales. Company Registration number: 1268689

Registered Office: Friars Gate, 1011 Stratford Road,
Shirley, Solihull, West Midlands B90 4BN

VAT Registration No. 864 4507 10



By buying this product you help take care of the world's forests.
FSC • C105481 • www.fsc.org