

Fixing

- The GRP SmartStack Chimneys must be installed by a qualified fitter under the supervision of a person responsible for technical matters on site.
- If the GRP SmartStack chimney does not have a pre-installed lead apron flashing the contractor must install a suitable lead flashing to The Lead Sheet Association Standard before the chimney is hoisted into position.
- The area on the roof to receive the GRP Chimney is prepared by installing support noggins inside the rafters and 18mm plywood panels level with the top of the rafters screwed at maximum 150mm centres to the noggins.
- Apply roofing felt over the area covered by the plywood panels.
- The GRP Chimney is lifted onto the prepared roof structure using the lifting eye, a 25 X 38mm batten is installed under the outside of the abutment gutter flange, running the full length of the gutter using 35mm round head screws provided.
- Where a lead flashing is included with the GRP Chimney a timber support fillet is fitted under the flashing to allow the flashing to be dressed onto the tiles correctly.
- The lifting eye is removed from the top of the chimney and the pot(s) are screwed fully onto the bolt provided, ensure the SmartStack pot is mastic sealed to the chimney.
- These instructions do not absolve the installer of the responsibility of checking the suitability of the chosen fixings are compatible with the type of roof construction being used. All fixings are to be installed in strict accordance with the manufacturer's instructions.
- Fitting instructions can also be obtained from BBA Certificate No. 18/5539.

Handling

- Mouldings can usually be carried manually.
- If mechanical handling equipment is used, always use suitable battens or bearers to protect the product.
- Remove the protective packaging only when fixing is imminent.
- Care should be taken not to damage the surface of the GRP.

Handling

- The GRP SmartStack Chimneys are delivered to site attached to a small timber pallet.
- Remove the GRP SmartStack Chimney from the timber pallet and hoist chimney onto the roof using the M.S. Lifting eye on top of the chimney pot.
- Remove the protective packaging only when fixing is imminent.
- Care should be taken not to damage the surface of the GRP.

Storage

- Always store the Chimney on the pallet provided on level ground, covered and dry.
- **If stored externally, do not expose to direct sunlight whilst inside the packaging.**



Maintenance

- GRP is low maintenance and will not require regular painting or decorating.
- To maintain its finish we advise cleaning periodically using an ammonia free detergent solution. Abrasive cleaners, wire wool or scourers should not be used as they may scratch the finished surface.
- Small areas of accidental site damage can be easily repaired, kits are available from Stormking for a small charge.

Technical helpline:

01827 311100

www.stormking.co.uk

STORMKING[®]

GRP BUILT OFF-SITE.
SAVE TIME ON-SITE.

GRP CHIMNEYS

SmartStack

Installation Instructions



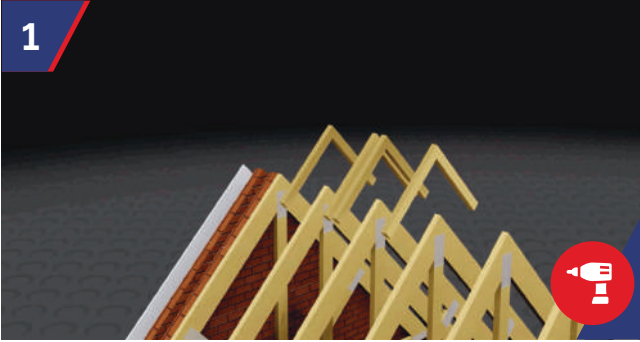

Fix support noggins to the inside of the rafters and insert external quality plywood panels between the rafters ensuring top of plywood is level with top of rafters.

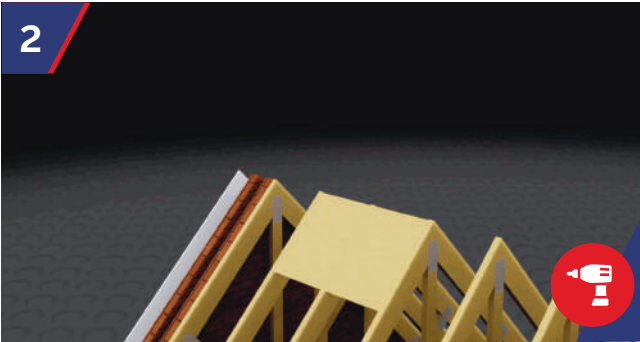

Screw fix the plywood panels to the noggins at a maximum 150mm centres and with minimum of 8 screws. It is imperative the plywood is securely fixed as the plywood will act as the main fixing point for the chimney.

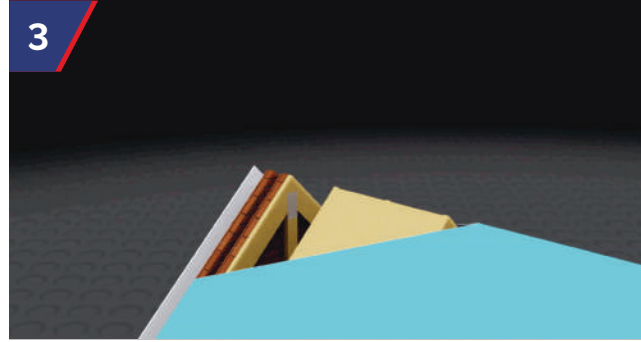

Apply roof felt over all of the roof including over the plywood panels. Only the area under the chimney needs to be felted during the lifting and fitting of the chimney. Lay the SmartStack chimney onto the roofing felt over the plywood panels, using the lifting eye situated within the SmartStack chimney pot.

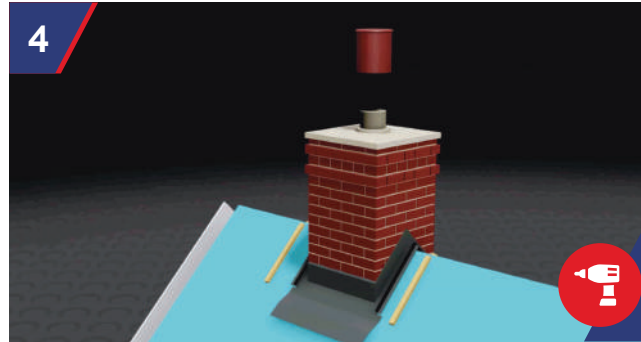

Insert tiling battens under the SmartStack gutter and simultaneously screw fix the GRP gutter and the tiling batten down onto the plywood using the screws supplied through all of the factory drilled holes. Unscrew lifting eye within SmartStack chimney pot and screw on SmartStack chimney pot onto threaded bolt.

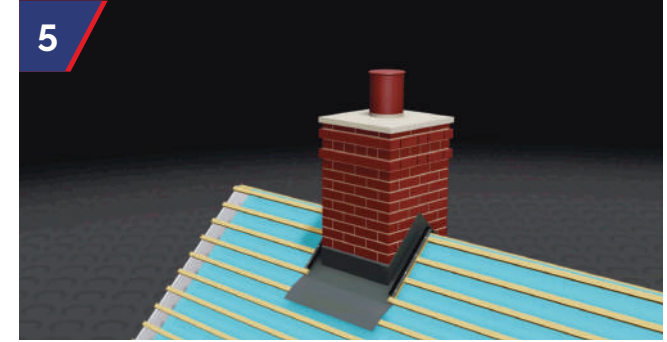

Batten out the roof. Lay a lead support fillet at the base of the chimney to ensure the lead is fully supported and on a continuous downward fall.

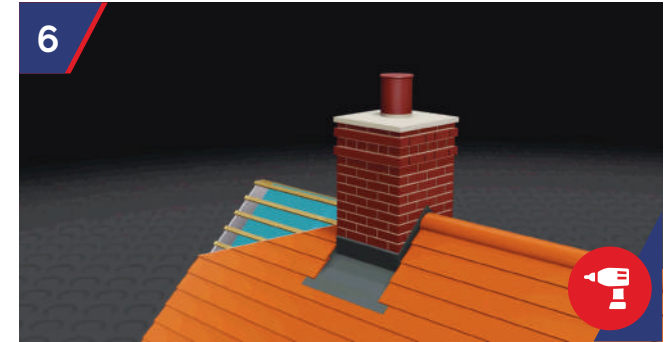

Using full and half tiles (tile and half preferred) set tiles within a maximum of 15mm from the side of the chimney. This inside tile now covers the foam strip. Drill and nail all abutment tiles and adjacent tiles.