

## Fixing

- Securely fix the plywood to the top of the wall, level and straight, fix the DPM to the top of the ply.
- Fix the continuous plastic fixing strip centrally to the plywood using two rows of 25mm coated wood screws 60mm apart at 300mm centres.
- The COPEKING® sections are clip fixed onto the fixing strip, stop ends have a fixing tape to be screwed to the fixing strip. Short COPEKING® sections are cut to suit the final length required, additional fixing cleats, supplied loose, are screwed into the cut section and clipped onto the fixing strip. The white clips factory fitted internally to the COPEKING® need to be fully located onto the fixing track.
- These instructions do not absolve the installer of the responsibility of checking the suitability of the chosen fixings are compatible with the wall construction. All fixings are to be installed in strict accordance with the manufacturer's instructions.

## Handling

- Mouldings can usually be carried manually.
- If mechanical handling equipment is used, always use suitable battens or bearers to protect the product.
- Remove the protective packaging only when fixing is imminent.
- Care should be taken not to damage the surface of the GRP.

## Storage

- Always store the COPEKING® on a level surface, covered and dry.
- If stored externally, do not expose to direct sunlight whilst inside the packaging.

## Maintenance

- GRP is low maintenance and will not require regular painting or decorating.
- To maintain its finish we advise cleaning periodically using an ammonia free detergent solution. Abrasive cleaners, wire wool or scourers should **not** be used as they may scratch the finished surface.
- Small areas of accidental site damage can be easily repaired, kits are available from Stormking for a small charge.

## Technical helpline:

01827 311100

[www.stormking.co.uk](http://www.stormking.co.uk)



**STORMKING®**

GRP BUILT OFF-SITE.  
SAVE TIME ON-SITE.

GRP COPING SYSTEM

**COPEKING®**

### Installation Instructions

Simply the safest and quickest coping to install.



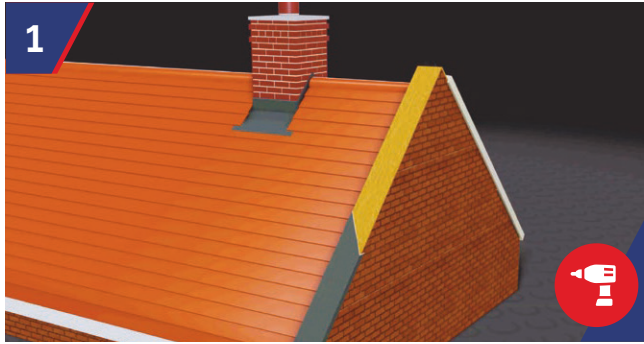

You will require an 18mm exterior quality plywood board to be fixed to the top of the wall. Weather proof the plywood with a polythene DPM or similar and cut off excess to allow 25mm overhang to each side of the plywood.

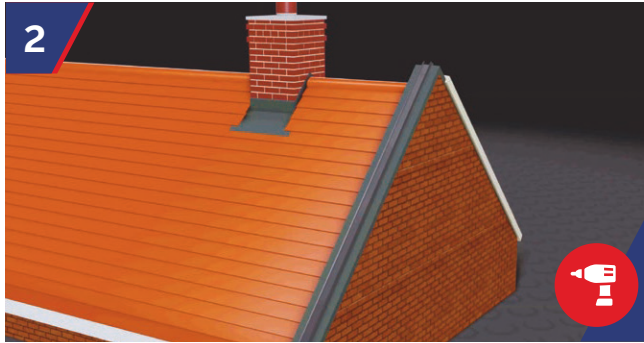

Fix the continuous plastic fixing strip to the plywood/DPM using two rows of 5x25mm coated wood screws (not supplied) spaced 60mm apart at 300mm centres. Ensure the fixing strip is central to the wall and adjoining lengths run in line. The fixing strip can be cut to any desired length to suit site conditions.

## Technical helpline:

01827 311100

[www.stormking.co.uk](http://www.stormking.co.uk)



Clip fix all the pre mitred internal, external angles, apex mitres, base mitres and stop end units by firmly pressing COPEKING® down onto the fixing strip until "clicked" into position.



For fitting COPEKING® stop end, take length of strap within clip pack supplied with each stop end. Attach half of strap to underside of stop end using 2 no. screws and washers supplied. Clip fit stop end onto fixing rail and slide to desired position. Ensuring the strap is pulled taut, screw fix remaining half of strap down through fixing rail and into parapet wall using x2 remaining screws and washers.



Clip all standard straight lengths between fixed junction units firmly pressing down onto fixing strip until "clicked" into position. If necessary, COPEKING® can be removed by gently prizing one side away from the wall until the holding down clip is released. Repeat for the other side. The white clips factory fitted internally to the COPEKING® need to be fully located onto the fixing track as indicated in the above close-up.



To complete a run of COPEKING® with a non-standard length of COPEKING®:

1. Measure the gap requiring COPEKING®.
2. Using a fine tooth saw or angle grinder, cut a section of COPEKING® to the desired length from one end of a standard COPEKING®. Ensure the cut section of COPEKING® does not have a feature joint at the end.
3. Fix the loose clip provided onto the underside of the COPEKING® at the cut end.
4. Clip fix the section of COPEKING® onto the fixing strip.