

Plan View ( 1:20 )

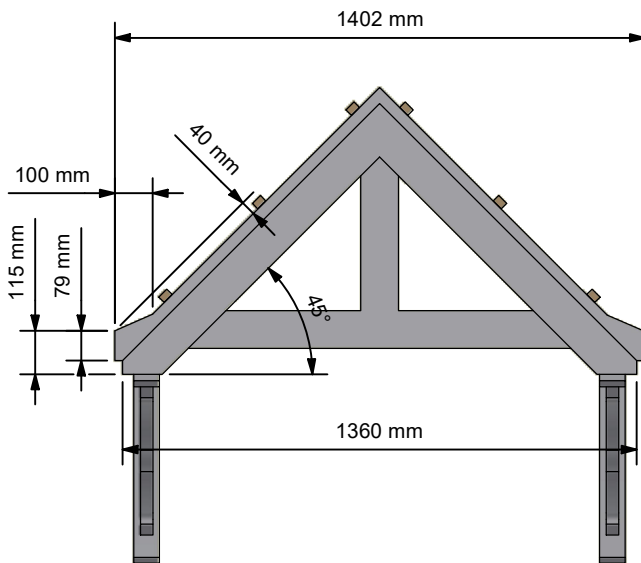

Front Elevation ( 1:20 )

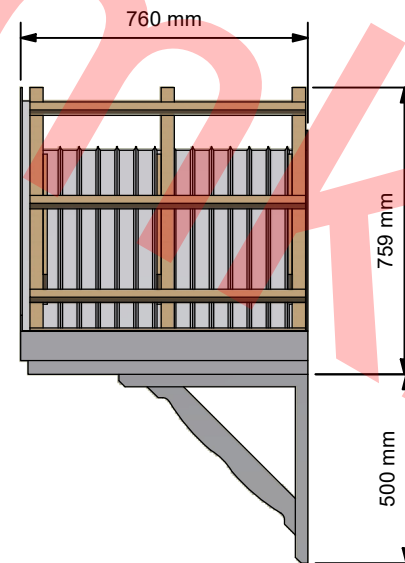

Side Elevation ( 1:20 )

Transport timber to be replaced on site by tiling battens nailed to all trusses.

Canopy to be fixed to the brickwork through the rear truss as per Stormking fixing instructions.

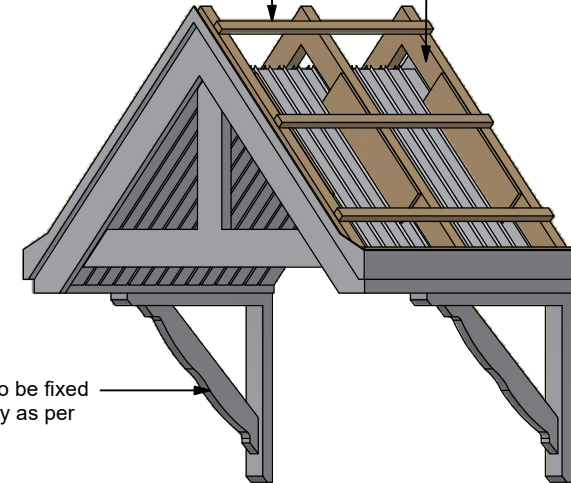

Auxiliary View ( 1:20 )

Gallows brackets supplied loose to be fixed to both brickwork and GRP canopy as per standard Stormking fixing details.

A.5	Added To New Vault	02/02/2023	DP
A.4	Timber Altered (12/11/2020)	02/02/2023	DP
A.3	Change Manufacture Notes (26/10/2020)	02/02/2023	DP
A.2	Revise Notes (18/10/2020)	02/02/2023	DP
A.1	1st Production Issue (03/09/2020)	02/02/2023	DP
A	1st Issue ( 11/08/2020 )	02/02/2023	DP
REV	DESCRIPTION	DATE	AUTHOR

REVISION HISTORY



Amington Point, Sandy Way, Amington Ind. Est,  
TAMWORTH, Staffordshire. B77 4ED

Description

GRP Trussed Apex Door Canopy

Designed by

Richard

Scale

Date

10/08/2020

Checked

DP

Manufacture Notes

1. New.

Approved

RS

Manuf. App

RS

Date

02/02/2023

Manuf. App

02/02/2023

Drawing Number

2008018

Sheet

1

Of

1

Revision

A.5