

### Front Elevation ( 1 : 25 )

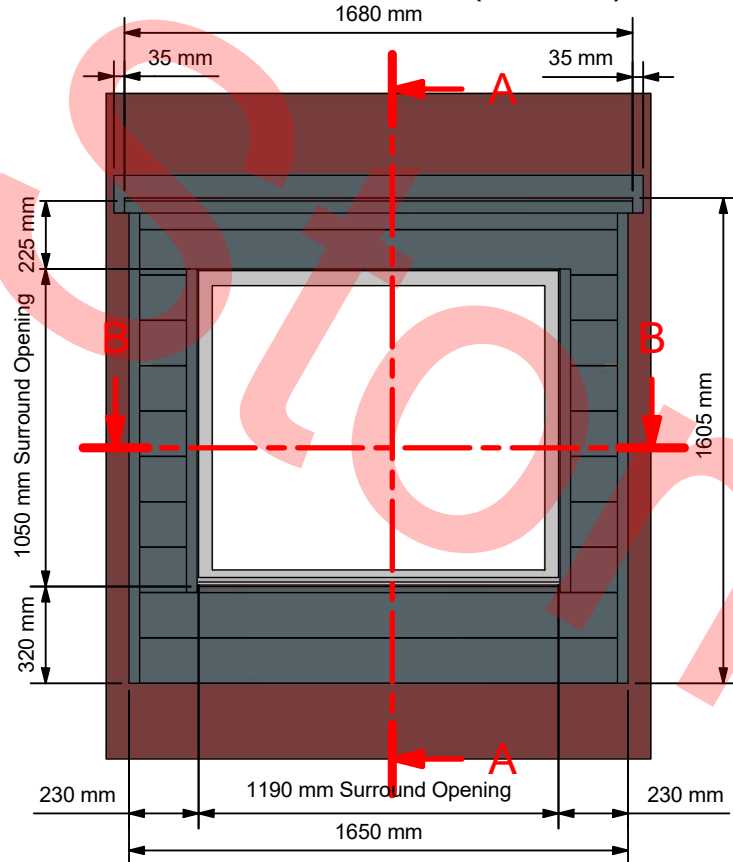

### A-A ( 1 : 25 )

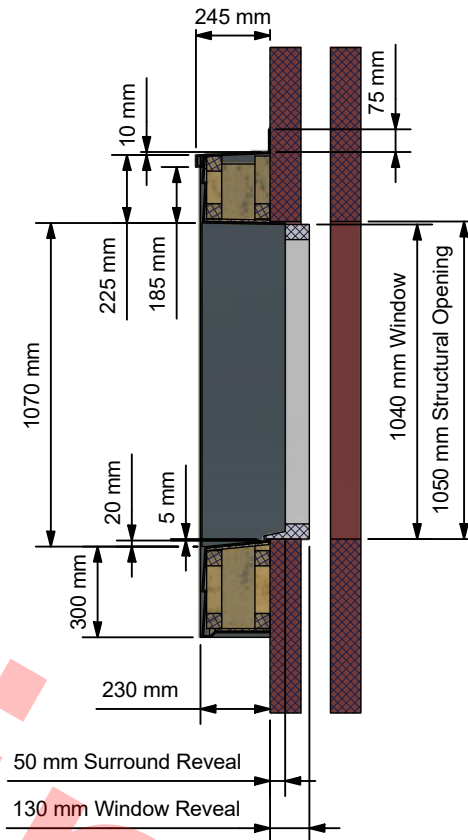

### C ( 1 : 8 )

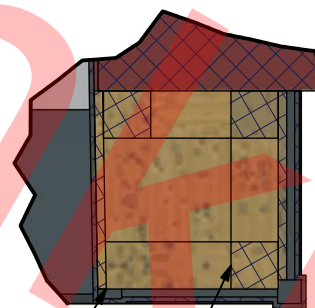

9mm Plywood supplied and fitted by Stormking to aid sliding the surround over the loose timber frame.

50mm square timber frame supplied loose by Stormking to be bolted to the structure.

### B-B ( 1 : 25 )

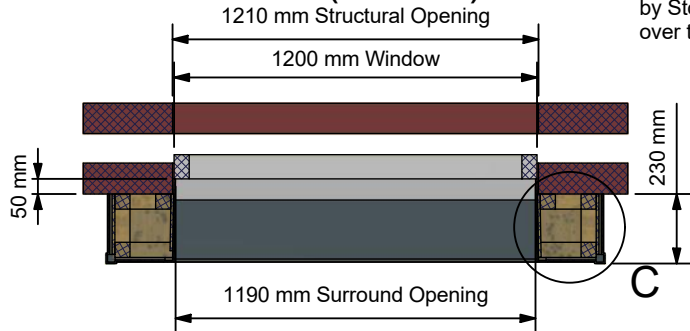

B.1	1st Production Issue	30/09/2021	Dan Priest
B	1040mm Window Was 1050mm	30/09/2021	Dan Priest
A	1st Issue	27/09/2021	Dan Priest
REV	DESCRIPTION	DATE	AUTHOR

#### REVISION HISTORY



Amington Point, Sandy Way, Amington Ind. Est,  
TAMWORTH, Staffordshire, B77 4ED

Description

Face Fixed Window Surround

Designed by

Dan Priest

Scale

Date

23/09/2021

Checked

RS

Manufacture Notes

1. New.

Approved

DP

Manuf. App

DP

Date

30/09/2021

Manuf. App

30/09/2021

Drawing Number

2109048

Sheet

1

Of

1

Revision

B.1