

External quality 18mm plywood bonded into block to receive fixings from above

Dentil block fixed by crew fixing with woodscrew through soffite board above down into plywood

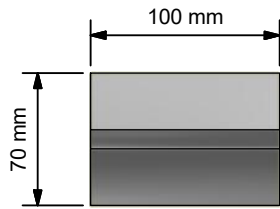

Plan View (1 : 4)

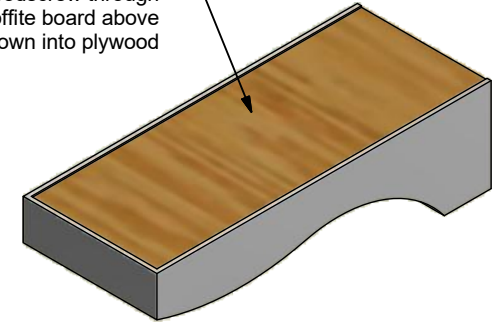

Front Elevation (1 : 4)

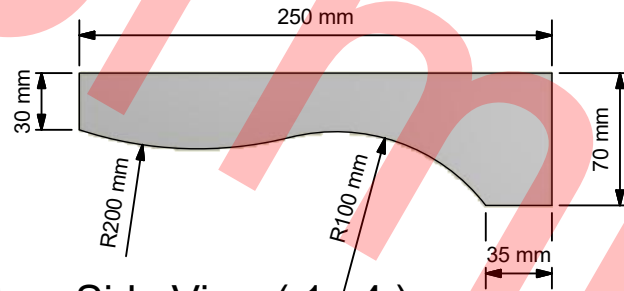

Side View (1 : 4)

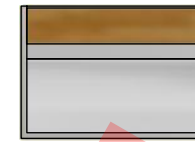

Rear View (1 : 4)

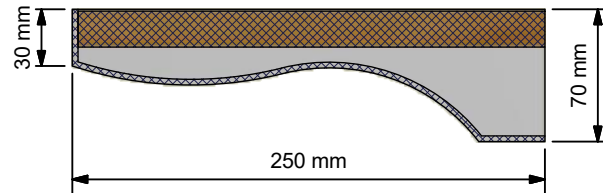

A-A (1 : 4)

A.1	1st Production Issue	22/11/2018	P O
A	1st Issue	21/11/2018	P O
REV	DESCRIPTION	DATE	AUTHOR

REVISION HISTORY

Approved	Date	Drawing Number		
PO	22/11/2018	1811044		
Manuf. App	Manuf. App	Sheet	Of	Revision
RS	22/11/2018	1	1	A.1



Amington Point, Sandy Way, Amington Ind. Est,
TAMWORTH, Staffordshire. B77 4ED

Description
250 x 100 x 70mm Dentil Block

Designed by	Date	Manufacture Notes 1. New
P O	20/11/2018	
Scale	Checked	
	RS	